

FOR OFFICE USE ONLY

Claim Nether Moor Farm Hfld 231

Ref

159/1

## PUBLIC RIGHTS OF WAY INFORMATION SHEET - WCA8

## Personal Details

Name ROBERT BATES. Date of Birth [REDACTED] 1944.

Address 4, SPRING FARM, DELVES, NETHERTON.  
HUDDERSFIELD. HD4 7BU.

## Telephone Numbers

Home [REDACTED] Daytime [REDACTED]

Occupation RETIRED (FARMER)

How many years have you lived at the above address 34 YEARS

Where did you live previously SPRING FARM, DELVES, NETHERTON  
FROM BIRTH - 1944.

How many years have you lived in the area 65 YEARS.

Year from 1944. Year to 2009.

The object of this questionnaire is to reach the truth of the matter, whatever it may be, You are therefore asked to answer the questions as fully as possible and not keep back any information, whether for or against the public claim. This is important if this information is to be of real value in establishing the status of the route. The information you give will eventually become public and may be used as evidence at a public enquiry

**This form should be completed by the one person who is named above - Please use black ink**

Please return the form to the person who supplied it to you.

If you have any queries regarding this form please contact:

Public Rights of Way Unit  
Highways Service  
Flint Street  
Fartown  
Huddersfield  
HD1 6LG  
Tel: 01484 225575

Huddersfield 231

6.7.2009

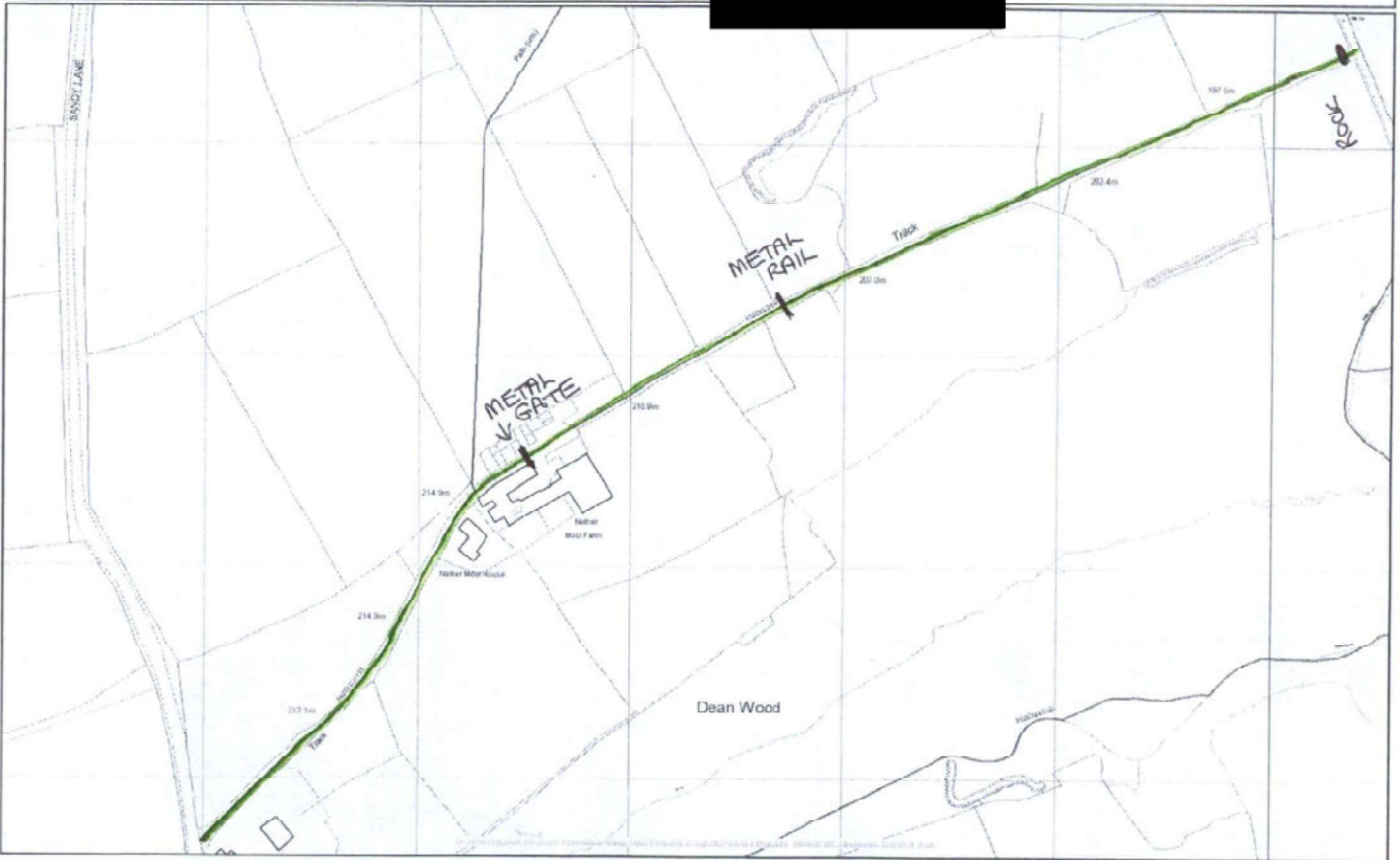

Used with the permission of the Controller of Her Majesty's Stationery Office  
© Crown Copyright. Unauthorised reproduction infringes Crown copyright and  
may lead to prosecution or civil proceedings. Kirklees Metropolitan Council,  
Licence Number 1000192 009

Scale 1/2500

Date 24/6/2009

Grid = 411732 E 413363 N



**PART A THE ROUTE**

Please describe the route and show it on the map opposite. The route referred to runs :

from

SANDY LANE

to

NETHER MOOR ROAD

In the District of: (\*Batley / Colne Valley / Denby Dale / Dewsbury / Heckmondwike / Holmfirth / Huddersfield / Kirkburton / Meltham / Mirfield / Spenborough)

circle where appropriate

Does the route have a name? YES/NO

If yes, please give details

Which of the following do you believe the route is

**Please tick one box**

Footpath (for use by walker only)

Bridleway (for use by walkers, horse riders, pedal cyclist)

Byway (for use by walkers, horse riders, pedal cyclist, motor vehicles and horse drawn vehicles)

Restricted byway (for use by walkers, horse riders and by vehicles other than MECHANICALLY propelled vehicles)

Not a PUBLIC right of way of any sort

If you think that the route is NOT A PUBLIC RIGHT OF WAY please give your reasons below

**PART B USE OF THE ROUTE**

Which years have you known the route (eg 2006)

From 1947

To 2009

Which years have you used the route (eg 2006)

From 1946

To 2009

For what purpose?

TO VISIT THE BRADLEY FAMILY WITH MY FATHER FROM AN EARLY AGE & LATER WHEN ABLE TO DRIVE EITHER TO VISIT OR HELP OUT. ALWAYS WITH TRACTOR AS THE LOWER PART OF THE ROUTE IS UNSUITABLE FOR MOTOR VEHICLES, CARS ETC.

How frequently did/do you use the route? (eg daily, weekly, once a month, once a year)

Have you seen other people using the route? YES/NO

If yes, for what purpose

HORSE RIDERS & WALKERS.

How did you travel?

On foot

On a horse

By bicycle

By motor vehicle

By horse drawn vehicle

Other (state)

BY  
TRACTOR

**PART C NATURE OF THE ROUTE**

How wide is the route used by the public?

(feet or metres)

9 FEET.

What is its surface?

ROUGH STONE & DIRT SURFACE

If you answer yes to the following questions, please mark the location on the map and give details

On the route, have you ever seen any stiles? YES NO

If yes, please give details (ie type and locations)

On the route, have you ever seen any gates? YES/NO

If yes, please give details (ie type and locations)

METAL GATE BY FARM BUILDINGS & METAL POLE HALF WAY DOWN LANE. (SEE MAP) USED TO MANAGE DAIRY MOVEMENT OF DAIRY HERD.

Were the gates ever locked? If so when?

NO.

On the route, have you ever seen any obstructions, such as fences, buildings etc? YES/NO

If yes, please give details ROCK PLACED TO BLOCK VEHICLE ACCESS AT NETHER MOOR ROAD END OF ROUTE. THIS IS TO PREVENT TRAVELLERS FROM GAINING ACCESS TO FARM LAND WHEN IN AREA, WHICH SEEMS TO BE FREQUENT IN THE PAST FEW YEARS. THIS IS A PRACTISE OTHER FARMS IN THE AREA HAVE HAD TO RESORT TO.

On the route, have you ever seen any notices? YES NO

If yes, please give details

On the route, have you ever seen any signposts or waymarks? YES/NO

If yes, please give details of location and wording of the notice.

Has anyone ever challenged you when using the route? YES/NO

If yes, who was it, when did it happen, how often and what did you do

Has the route always run over the same line? YES/NO

If no, please give details and dates of changes

Has the surface or any structure on the route been maintained by the local authority? YES/NO

If yes, please give details

#### PART D

Land Owner

If known please give name(s) and address(es) of the owner(s) and or occupier (s) of the land over which the line crosses

EDWARD BRADLEY  
NETHER MOOR FARM.  
SOUTH CROSLAND.

Have you ever been give permission to use the route by the landowner? YES/NO

If yes, please give details

TO TRANSPORT HAY BY TRACTOR & TRAILER FROM  
SANDY HANE TO NETHER MOOR ROAD.  
WITH PERMISSION SOUGHT ON EACH OCCASION

Have you ever been employed by the owner or occupier of the land? YES/NO

If yes, please give details

If you were ever employed by the owner or occupier of the land what instructions or information, if any were you given about the route?

Have you or your family ever owned or rented any land or property crossed by or adjacent to the route?

If yes, please give details

NO.

Have you at any time had a legal interest in the land?

If yes, please give details

NO.

Are you aware of any old maps, deeds, photographs or any other documentary evidence that record or show this route and which may be of assistance in determining its status?

ORDNANCE SURVEY NO

Is there any other information which you feel would be of assistance?

AS FOURTH GENERATION FARMING NEIGHBOURS OF THE BRADLEY FAMILY OF NETHER MOOR FARM, IT HAS ALWAYS BEEN THE UNDERSTANDING OF MYSELF & FAMILY THAT THE ROUTE IN QUESTION WAS FOR THE SOLE USE OF ACCESS TO NETHERMOOR FARM & LAND, & NOT AS A PUBLIC ROAD FOR MOTOR VEHICLES. SINCE CHILDHOOD I HAVE USED THE ROAD TO VISIT THE BRADLEY FAMILY BY TRACTOR WITH MY FATHER. LATER IN MY LIFE I HAVE OCCASIONALLY DONE CONTRACT WORK FOR THE FAMILY & USED THE ROUTE AS ACCESS TO THEIR LAND. ON OCCASION OVER THE YEARS I HAVE USED

Would you be prepared to attend a hearing, Public Inquiry or Court and give evidence if the need arose?

YES.

THE ROUTE TO TRANSPORT LOADS OF HAY BY TRACTOR & TRAILER FROM SANDY HANE TO NETHER MOOR ROAD, BUT ONLY AFTER HAVING SOUGHT & BEEN GIVEN PERMISSION BY THE OWNERS.

I hereby certify that to the best of my knowledge and belief, the facts that I have stated are true

Signed



Date

JULY 6TH, 2009.

ON THE ATTACHED MAP, PLEASE MARK THE ROUTE REFERRED TO IN THIS STATEMENT  
PLEASE MARK ANY NOTICES, GATES, STILES, FENCES ON THE ROUTE YOU HAVE REFERRED TO  
**PLEASE SIGN AND DATE THE MAP**